



ISO 9001 Certified

# 5000EM Series

## Sensor Operated Faucet

### Installation Instructions

- Prior to installing this faucet, thoroughly flush all water lines and replace stop washers as may be required.
- Unscrew the **Mounting Nut (13)** from the **Mounting Rod (8)** and completely remove both the **Mounting Nut (13)** and **Star Locking Washer (12)**. Ensure the **Rubber Gasket (11)** remains on the faucet body.
- From above the deck, carefully feed the **Mounting Rod (8)** into the deck mounting hole and adjust the faucet in the correct position.
- From below the deck, slide both the **Star Locking Washer (12)** and the **Mounting Nut (13)** onto the **Mounting Rod (8)** and tighten **Mounting Nut (13)** to secure faucet to the deck.
- Rotate the **Locking Screw (10)** fully clockwise, then insert the O-ring end of the **Supply Tubes (14)** into the bottom of the **Mounting Rod (8)** until properly seated. Turn the **Locking Screw (10)** counterclockwise until the markings on the **Mounting Rod (8)** and the **Locking Screw (10)** are properly lined up. Gently pull down on the supply tubes to confirm they are properly seated in the **Mounting Rod (8)**.
- Install both **In-line Filters (15)** onto the stop valves.
 

**USE TEFLON TAPE FOR ALL CONNECTIONS, NO PIPE DOPE**
- Connect the **Supply Tubes (14)** to the **In-line Filters (15)** using the swivel quick connect nuts.
- To allow for proper sensor calibration, empty the sink basin prior to installing the power supply.
  - AC Powered:** Plug-in the **AC Power Adapter (17)** into a 120V outlet and connect it to the **AC Cord Pigtail (18)**.
  - Battery Powered:** Using the security screw allen key included in the box, remove the **Top Cover (1)** by loosening up the **Security Screw (6)** next to the **Aerator (5)**. Remove the **Battery Holder Cover (3)** and install the 4 AA batteries provided, into the **Battery Holder (4)**. Reinstall the **Battery Holder Cover (3)** and tighten the screws. Reinstall the **Top Cover (1)** onto the **Faucet Body (7)** and tighten the **Security Screw (6)**.
- Once the power supply is installed, allow 15 seconds for the faucet to complete the auto calibration process before activating the faucet.
- Turn the water supply ON and check for possible leaks.
- Place your hands under the faucet to activate the sensor. Water should flow automatically and should stop once you remove your hands, or after 20 seconds of continuous activation.
- Retain the security screw allen key for future maintenance and battery replacements.
- The faucet's water temperature can be adjusted by rotating the **Temperature Adjustment Knob (9)** to the desired setting.
- The sensor can be bypassed for manual operation by pulling the **Temperature Adjustment Knob (9)** outward from the faucet body; pushing the knob inward returns the faucet to automatic sensor mode.
- IMPORTANT:** This product contains mechanical and/or electrical components that are subject to normal wear. Periodic cleaning and maintenance for the **In-line Filters (15)** as well as the **Aerator (5)** is recommended to maintain the faucet's performance.

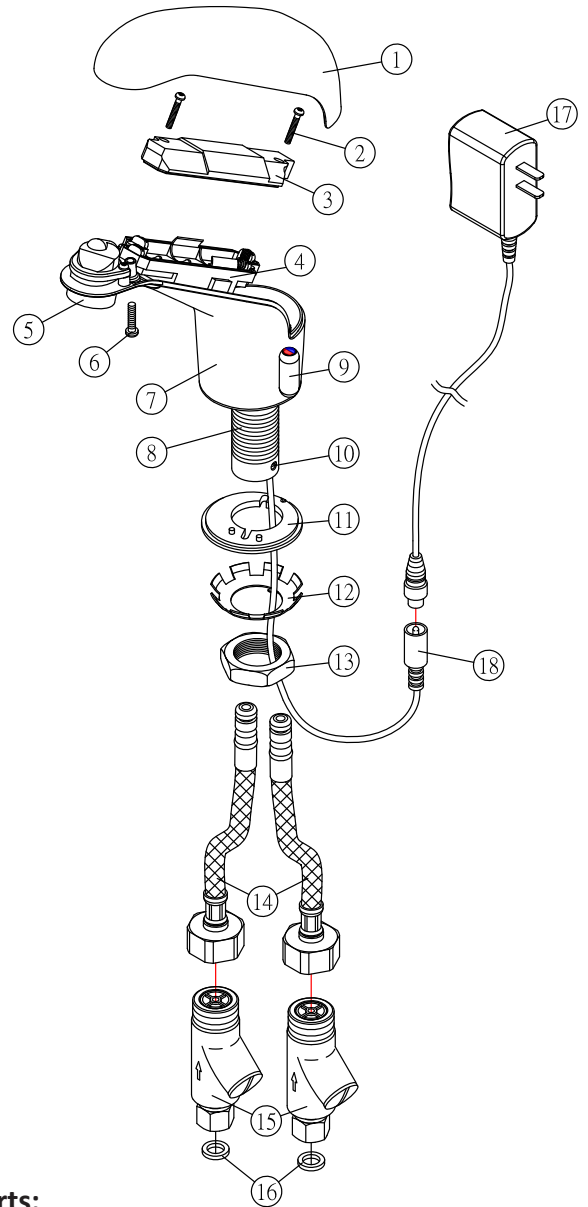

#### Parts:

1. Top Cover	11. Rubber Gasket
2. Battery Holder Screws (2)	12. Star Locking Washer
3. Battery Holder Cover	13. Mounting Nut
4. Battery Holder	14. Supply Tubes
5. Aerator	15. In-line Filters
6. Security Screw	16. Nylon Washers (Installed)
7. Faucet Body	17. AC Power Adapter (AC models only)
8. Mounting Rod	18. AC Cord Pigtail (AC models only)
9. Temp. Adjustment Knob	
10. Locking Screw	

**IMPORTANT:** (1) For outdoor installations, the faucets must be installed in fully enclosed spaces where they are completely shielded from direct sunlight, as exposure to the sun can affect performance. Hydrotek International, Inc. is not liable for any damages, malfunctions, or performance issues caused by exposure to direct sunlight.

(2) Additionally, the stop valve must not be opened beyond the point where water flow exceeds the sink drain's capacity. The sink's drain and plumbing must accommodate continuous water flow from the faucet to prevent overflow. Hydrotek is not responsible for any damages resulting from sink overflow caused by water flow exceeding the capacity of the drain or pipes. Proper installation and operation are the user's responsibility.

**HYDROTEK INTERNATIONAL, INC.**  
 5055 Forsyth Commerce Rd., Ste 124  
 Orlando, FL 32807  
 800.922.9883 (Phone)  
 866.670.5580 (Fax)  
 www.hydrotekintl.com



## HYDROTEK 5000 SERIES INSTALLATION TROUBLESHOOTING GUIDE

OPERATION: When power is connected, the unit will automatically begin to perform the setup procedure. You will hear a click sound and the sensor light will flash. Once setup is complete, water will flow when the sensor is activated by placing the user's hands under the spout and will continue to flow for the duration of the sensor activation. Water flow will automatically stop once the user's hands are removed. Periodic maintenance is required for smooth and trouble-free operation.

PROBLEM	SYMPTOM	POSSIBLE CAUSE	SOLUTION
No water flow after installation	Solenoid clicking is detectable	No water at supply	Make sure the stop valves are turned on
	Solenoid clicking is undetectable	No power to the PCB	Battery Models: Remove and reinstall all AA batteries  AC Models: Check the outlet to make sure there is power to it
Continuous water flow or dripping after installation	Solenoid clicking is detectable	Solenoid valve is stuck open	Clogged/Defective solenoid valve. Turn water off at the supply. Contact <i>Hydrotek Technical Support</i> for further assistance
	<b>**EM models ONLY**</b> Solenoid clicking is detectable	Manual temperature knob in open position	Push the temperature knob inwards against the faucet body
	Solenoid clicking is undetectable	Solenoid actuator is in open position	Check the power source to make sure there is power supplied to the PCB
Faucet is ghost activating	Water turns on and off intermittently without anyone activating it	Sensor calibration is off	Battery Models: Ensure sink basin is empty. Remove all 4 AA batteries, wait 10 seconds, reinstall batteries, allow for faucet to calibrate without any interruption (15 seconds)  AC Models: Ensure sink basin is empty. Unplug the power supply, wait 10 seconds, reconnect, allow for faucet to calibrate without any interruption (15 seconds)
Limited water flow after each activation	Low line pressure	Stop valves have restricted flow	Make sure stop valves are fully turned on

*For issues beyond the steps of this troubleshooting guide, please call:*

**Hydrotek Technical Support  
(800)922-9883**

### Care and Cleaning Instructions:

- **WARNING!** Using abrasive or chemical cleaners *will* damage the chrome or decorative finishes.
- Use only soap and water to clean the finish, then wipe dry with a clean cloth.
- If chemical cleaners are used for other parts of the lavatory, ensure that the faucet is protected from potential contact from those cleaners.