



Sensor Faucets and Flush Valves

HE-4100CLR

Battery Powered with ENDURATEK Sensor Operated Mixing Faucet

Installation Instructions

Installation Instructions:

1. The spout nut(2) and spout gaskets(3) will come assembled on the spout(1). Insert the spout into the receptacle on the body(4) and tighten down the spout nut(2) to secure the spout.
2. Remove the washer(7) and lock nuts(8) and slide the faucet supply rods through the deck hole. If there are 3 holes, use the cover plate(4"or 8") from Hydrotek, call 800-922-9883. If desired, slide the wire bracket(12) onto a mounting rod(5). Tighten faucet to deck using washer(4) and lock nuts(5).
3. Connect in-line filters(10) to the supply tubes and the in-line filters to the stop valves. A 3/8" union connector (**provided by others**) is required to connect the inline filters to the stop valves.
4. Insert 4 AA batteries into the battery holder(11) and attach the battery holder(11) to the power connector(6). Wait 10 seconds for the sensor to self-adjust, then place hand in front of spout, it should click. If not, check the connection between the AC connector and plug-in adapter.
5. Turn on water from the stop valve and check for leaks.
6. Place hand in front of the sensor eyes, water should start to flow. Remove hands, water stops.
7. **IMPORTANT:** The control stop valve should never be opened to the point where the flow from valve exceeds the flow capability of the sink fixture. In the event of a valve failure, the sink fixture must be able to accommodate a continuous flow from the valve.
8. **IMPORTANT:** This product contains mechanical components that are subject to normal wear. Periodical maintenance is required in order to maintain the faucet performance.
9. **DO NOT USE** abrasives, acids or cleaning fluids to clean Hydrotek Sensor faucet. Use only soap and water then wipe with clean cloth or towel.

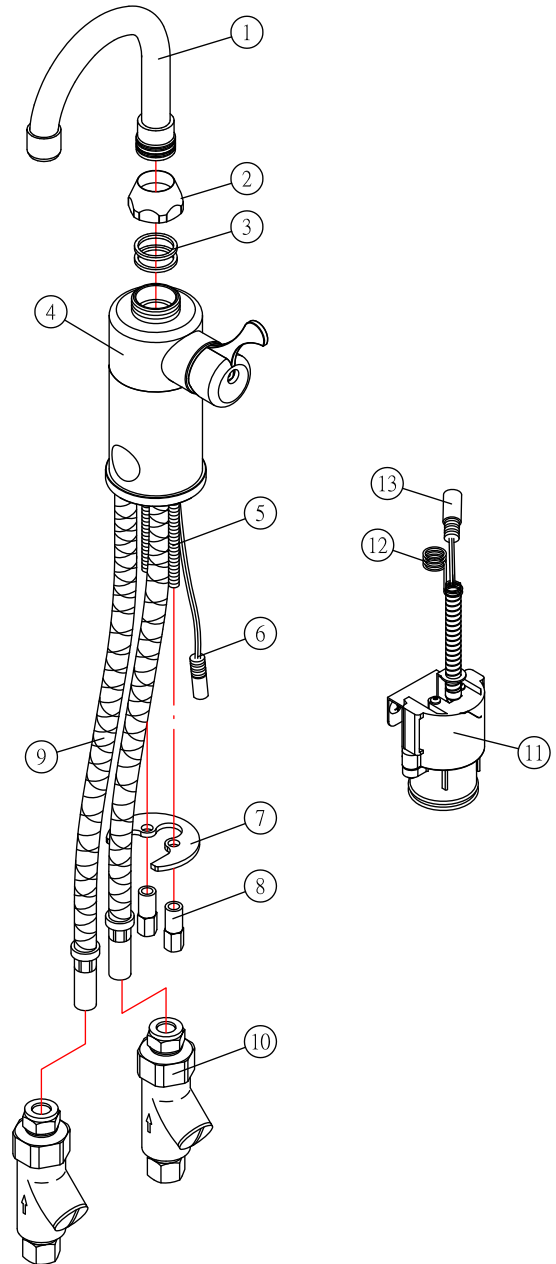

Parts:

- | | |
|--------------------|-----------------------|
| 1. Gooseneck Spout | 8. Lock Nuts |
| 2. Spout Nut | 9. Supply Tubes |
| 3. Spout Gasket | 10. Inline Filters |
| 4. Body | 11. Battery Holder |
| 5. Mounting Rod | 12. Wire Bracket |
| 6. Power Connector | 13. Battery Connector |
| 7. Washer | |

HYDROTEK INTERNATIONAL, INC.
 5055 Forsyth Commerce Rd., Ste 124
 Orlando, FL 32807
 800.922.9883 (Phone)
 866.670.5580 (Fax)
 www.hydrotekintl.com

