

HYDROTEK INSTALLATION INSTRUCTIONS

HB-6300LR Automatic Faucet (DC Powered)

Parts Table

No.	Description	No.	Description
1.	Gooseneck Spout Assembly	8.	Filter
2.	Body	9.	Battery Holder
3.	Mounting Bolt	10.	Battery Holder Connector
4.	Control Cable		
5.	Mounting Washer		
6.	Mounting Nut		
7.	Supply Tube		

Installation Instructions

1. Prior to installing this faucet, thoroughly flush all water lines.
2. **USE TEFLON TAPE, NOT PIPE DOPE FOR ALL CONNECTIONS.**
3. Position faucet by lowering Supply Tube (9) and Control Cable (6) through deck hole. Secure faucet to sink deck using Mounting Washers (7) and Mounting Nuts (8).
4. Attach Inline Filter (10) to stop valves using Nylon Washers inserted into filter inlet. Attach Supply tubes (9) to Filter Compression Fittings. Filters may be cleaned by using a screwdriver to open the clean out trap and remove the screen.
5. Mount Gooseneck Spout assembly (1) onto Body (2).
6. Plug Control Cable (6) connector into the Battery Holder (12). Insert batteries into battery holder.

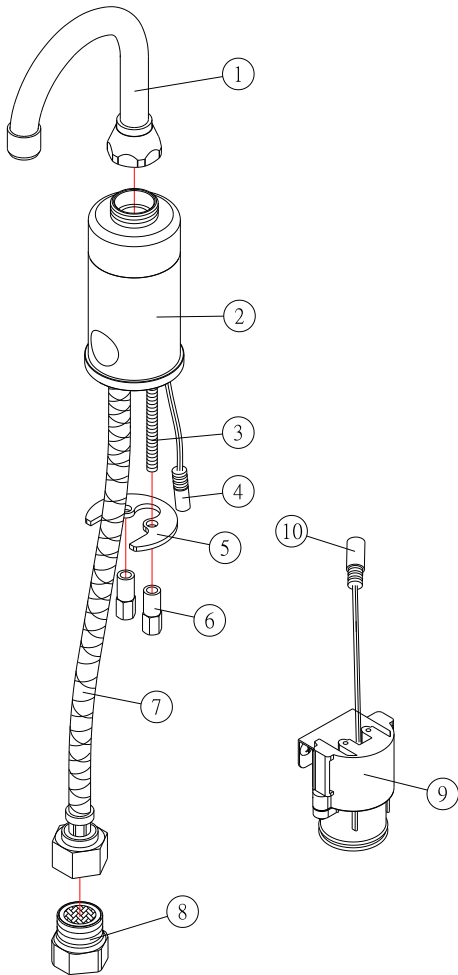

7. IMPORTANT: FIRST, properly install batteries and **THEN** turn on water. Place your hand in front of faucet sensor eye to activate water flow. Remove hand and flow should stop. If not, refer to Troubleshooting Guide.

8. IMPORTANT: The stop valve should never be opened to the point where the water flow exceeds the flow capability of the fixture. The fixture must always be able to accommodate the continuous water flow from the valve in the event of a valve failure. Should the fixture overflow happen due to water exceeding the capability of the fixture & or the drain pipe, Hydrotek will not be responsible for any flood damages.

9. IMPORTANT: This product contains mechanical and/or electrical components that are subject to normal wear. These components should be checked regularly (1 year is recommended) and replaced as needed to maintain the Faucets performance. Call 800-922-9883 for further details.

10. IMPORTANT: DO NOT use abrasives, acids or cleaning fluids to clean the Hydrotek Faucet as they may dull the luster and attack the chrome or special finishes. Use only soap and water then wipe with a clean cloth or towel.

TROUBLESHOOTING

PROBLEM	POSSIBLE CAUSE	TO DIAGNOSE	REMEDY
Faucet Will Not Turn On	Water not on	Check water supply.	Turn on water supply
	Power failure.	No light, no click: Check batteries.	Re-install or replace batteries.
	Low battery.	Light continues to flash.	Replace batteries.
	PCB/Sensor Is defective.	No light, no click : Re-insert batteries.	Replace electronic PCB.
	Solenoid Valve Is clogged.	Solenoid is clicking but No water.	Clean solenoid.
	In-line Filter is Clogged.	Open clean-out trap and check filter.	Clean or replace Filter.
	Solenoid Coil is Defective.	Insert new batteries, Light blinks, but no clicking.	Replace solenoid coil.
Faucet Will Not Shut Off, Low Flow Drips.	Flow Control is Clogged.	Open flow control device And check.	Clean the flow control device.
	Solenoid valve is normally closed. Turn off water and activate the faucet, if there is a clicking sound, then the solenoid is dirty. If there is no clicking sound, then check solenoid valve. If faucet has a low flow or is dripping, clean solenoid valve.		



Hydrotek International, Inc.
1.800.922.9883 (Phone)
1.866.670.5580 (Fax)
www.hydrotekintl.com