

# INSTALLATION INSTRUCTIONS

## Hydrotek Non-Mixing Automatic Faucet (AC Powered)

1. Prior to installing this faucet, thoroughly flush all water lines and replace stop washers, if necessary.
2. To ensure proper operation, " DRY TEST " the faucet by plugging the Power Adapter (1) into a wall outlet and connecting the Power Adapter output lead to the faucet Input Wire Lead (12). The faucet should immediately perform a self-adjustment and diagnostic function. If you see the indicator light flash and hear a clicking sound, proceed to the next step. If there is no flash of light or clicking sound, recheck power source and connections.
3. Unplug Power Adapter (1) from the wall outlet. Disconnect the Power Adapter output lead from the faucet's AC Input Lead (12).
4. Rotate the Supply Tube Locking Screw (5) fully clockwise. Insert the end of the Supply Tube (9) (with O-rings) fully into the bottom of the Mounting Rod (4) by twisting and pushing until properly seated. Rotate Supply Tube Locking Screw (5) counter-clockwise to lock the Supply Tube into the Mounting Rod.
5. Attach the faucet's AC Input Lead (12) armored cable bracket to the bottom of the Mounting Rod (4) using the existing Mounting Rod screws.
6. Install In-Line Filter (10) onto stop valve using the Nylon Washer (11).
7. Unscrew the Mounting Nut (8) from the Mounting Rod (4) and completely remove both the Mounting Nut (8) and the Star Locking Washer (7).
8. From above the deck, carefully feed the faucet's AC Input Lead (12), Supply Tube (9), and Mounting Rod (4) into the deck mounting hole and seat the faucet in the correct mounting location.
9. From below the deck, feed the AC Input Lead (12) and Supply Tube (9) through the keyed Star Locking Washer (7) and Mounting Nut (8). Slide the Locking Washer and Mounting Nut up onto the Mounting Rod (4) and tighten Mounting Nut on the Mounting Rod to securely lock faucet to the deck.
10. Connect the Supply Tube (9) to the In-Line Filter compression fitting (10) and securely tighten.
11. Connect the Power Adapter (1) output lead to the faucet's AC Input Lead (12). Plug the Power Adapter into the electrical wall outlet.
12. Turn water on and check for leaks. Place your hands under the faucet spout to activate water flow. Remove hands and water should stop.

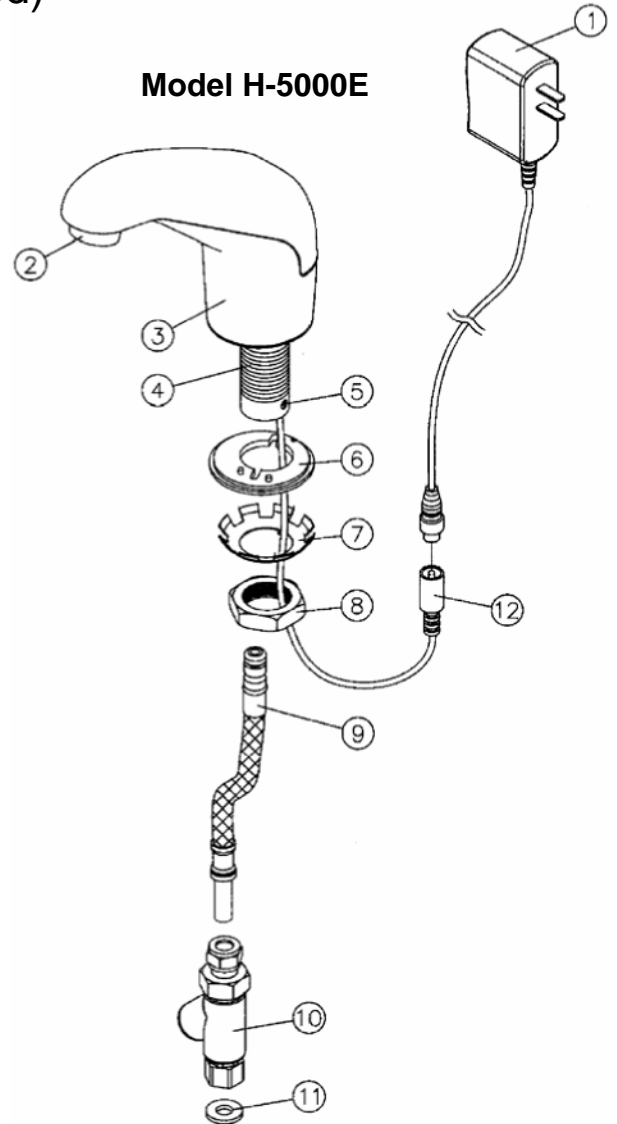

Part Number Descriptions	
1. Power adapter	7. Star locking washer
2. Flow control	8. Mounting nut
3. Faucet body	9. Supply tube
4. Mounting rod	10. In-line filter
5. Supply tube locking screw	11. Nylon washer
6. Gasket	12. AC input lead

**HYDROTEK INTERNATIONAL, INC.**  
 5055 Forsyth Commerce Rd. , Ste. 124  
 Orlando, FL 32807  
 1.800.922.9883 (Phone)  
 1.866.670.5580 (Fax)  
 www.hydrotekintl.com